

Technical Data Sheet

Ceramic Disc Magnets

Ceramic magnets are sintered from Strontium (Sr) Ferrite (Fe). Their higher coercive properties result in a more useful operating slope and high max operating temperature. Ceramic 8 Magnets have a higher coercive properties which result in a more useful operating slope. Like Ceramic 5, it is a highly oriented material and must be magnetized in the direction of orientation.

Product Specifications

Shape:	Disc
Tolerance:	.005
Material:	SrFe
Plating:	None
Max. Operating Temperature:	480°
Br. Max:	3850
BH Max:	8

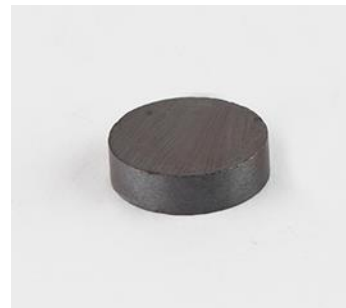

Part No.	Diameter	Thickness	Price
DH912	.710	.200	\$0.18

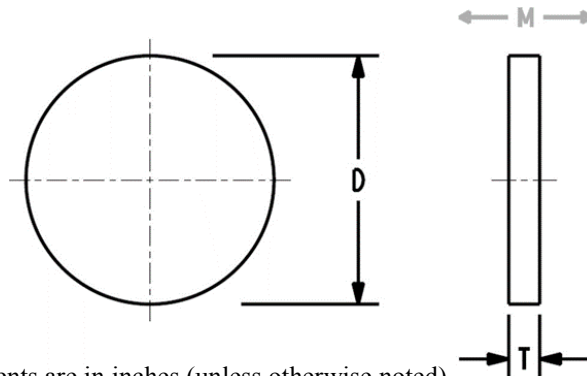

- All Measurements are in inches (unless otherwise noted)
- Direction of Magnetization (DOM) is through the thickness unless noted
- Unless otherwise specified, magnets will be furnished in magnetized condition
- Holding forces are approximate. These are average values obtained under laboratory conditions. Size, shape, and material of the test piece may affect actual pull forces