

Technical Data Sheet

Alnico Horseshoe Magnet, Narrow, Grade 5

Alnico magnets are widely used in industrial and consumer applications where strong permanent magnets are needed; examples are electric motors, electric guitar pickups, microphones, sensors, loudspeakers, traveling wave tubes, and cow magnets.

Product Specifications

| | |
|------------------------------------|-----------|
| Shape: | Horseshoe |
| Tolerance: | .005 |
| Material: | AlNiCo |
| Plating: | None |
| Max. Operating Temperature: | 1000° |
| Br. Max: | 12700 |
| BH Max: | 5.5 |



| Part No. | A | B | C | D | E | R | r | Wt. (lbs) | Holding Force (lbs) | Price |
|----------|-------|------|------|------|------|------|------|-----------|---------------------|--------|
| CH750 | 1.094 | .719 | .250 | .422 | .344 | .562 | .250 | .042 | 6.5 | \$7.90 |

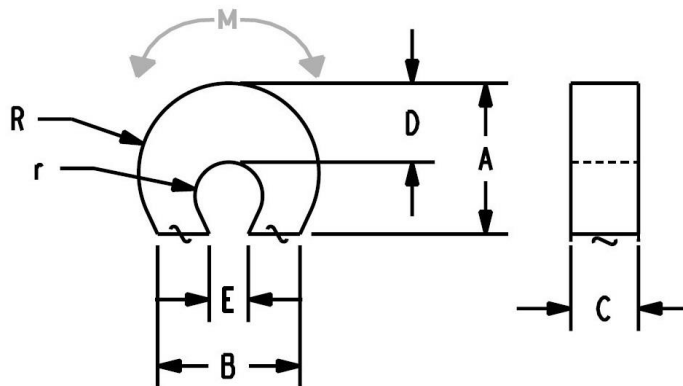

- All Measurements are in inches (unless otherwise noted)
- Direction of Magnetization (DOM) is through the thickness unless noted
- Unless otherwise specified, magnets will be furnished in magnetized condition
- Holding forces are approximate. These are average values obtained under laboratory conditions. Size, shape, and material of the test piece may affect actual pull forces