



GLOBAL. MAGNETIC. FORCE.™

## Technical Data Sheet

### Neodymium Cartridge Magnets, Power-Balanced

The standard cylindrical model is 1" in diameter and is available in lengths from 4" to 24". These cartridges contain neodymium magnets to attract medium ferrous pieces like small screws, metal chips, washers, nuts, etc. The cartridge center-to-center distance between trays should not exceed 2". Cartridge magnets may also be referred to as "tube magnets" in the industry.

#### Product Specifications

**Shape:** Cylinder  
**Tolerance:** .005  
**Material:** NdFeB



Part No.	Length	Pull Strength (lbs)	Gauss	Price
C4012NPB	12	6.1	10,000	\$179.00

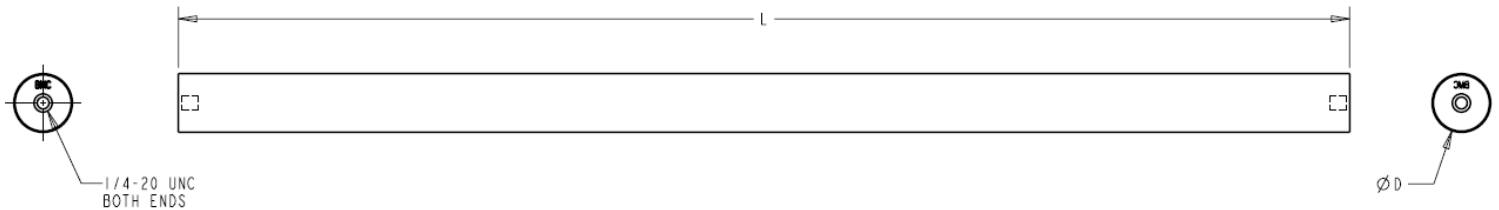

- All Measurements are in inches (unless otherwise noted)
- Direction of Magnetization (DOM) is through the thickness unless noted
- Unless otherwise specified, magnets will be furnished in magnetized condition
- Holding forces are approximate. These are average values obtained under laboratory conditions. Size, shape, and material of the test piece may affect actual pull forces



1150 Howard Street • Elk Grove Village, IL 60007 • 800-232-4359 or 847-593-2060